

# Connectors & Tools

## Tools

Identifying the proper tools for a job, making sure that you have all of the necessary tools and storing them in a way that is quickly accessible when working remote on a job site, has been a timeless struggle.

The Times Microwave Systems hard case tool kits include hard foam cut-outs that will keep all of the tools required for a specific job all in one place. All it takes is a quick flip of the lid to make sure you have everything you need.

### TK-195/200/240EZ-HC

- For LMR-195, 200 and 240 • X series connectors
- **CT-240/200/195/100**  
Crimp tool for LMR 100/195/200/240 connectors
- **CST-240A**  
Prep tool for LMR-240
- **CST-195/200**  
Prep tool for LMR-195/200 connectors
- **CCT-03**  
Cable cutting tool for LMR-100 through LMR-400



660-1206



### TK-400/400-75EZ-HC

- For LMR-400 and 400-75 • X series connectors
- **CT-400/300**  
Crimp Tool for LMR 400 and LMR 300
- **CST-400-75**  
Prep tool for LMR 400-75
- **CST-400**  
Prep tool for LMR 400
- **CCT-03**  
Cable cutting tool for LMR-100 through LMR-400



660-1266



### TK-CST-HC (Prep Tool Kit)

- For LMR, LMR-DB, and LMR-FR
- **CST-195/200**  
Prep tool for LMR 195/200
- **CST-240-PX**  
Prep tool for LMR 240-LLPX
- **CST-240A**  
Prep tool for LMR 240
- **CST-400-PX**  
Prep tool for LMR 400-LLPX
- **CST-400**  
Prep tool for LMR 400
- **CST-600-PX**  
Prep tool for LMR 600-LLPX
- **CST-600**  
Prep tool for LMR 600



660-1268



Connectors	Gender	Description	Coupling Nut	Part Number	Stock Code	Connector Code
4310M	Male	Straight Plug	Hex	<b>EZ-195-200-4310M-X</b>	3190-8092	43M
4310M-RA	Male	Right Angle	Hex	<b>EZ-195-200-4310M-RA-X</b>	3190-8093	43MR
7/16 Din	Male	Straight Plug	Hex/Knurl	<b>EZ-195-200-716M-X</b>	3190-8102	DM
		Right Angle	Hex/Knurl	<b>EZ-195-200-716M-RA-X</b>	3190-8103	DMR
BNC	Male	Straight Plug	Knurl	<b>EZ-195-BM-X</b>	3190-6141	BM
FME	Female	Straight Jack	Hex	<b>TC-195-FMEF-X</b>	3190-6249	FMEF
N	Female	Bulkhead	N/A	<b>EZ-195-NF-BH-X</b>	3190-6401	NFB
		Straight Jack	N/A	<b>EZ-195-200-NF-X</b>	3190-8091	NF
	Male	Straight Plug	Hex/Knurl	<b>EZ-195-NMH-X</b>	3190-6497	NM
		Right Angle	Hex/Knurl	<b>TC-195-NMH-RA-D</b>	3190-6542	NMR
QMA	Female	Straight Jack	N/A	<b>EZ-195-QF-X</b>	3190-6384	QF
	Male	Straight Plug	Knurl	<b>EZ-195-QM-X</b>	3190-6383	QM
QN	Female	Straight Jack	N/A	<b>EZ-195-200-QNF-X</b>	3190-8040	QNF
	Male	Straight Plug	N/A	<b>EZ-195-200-QNM-X</b>	3190-8038	QNM
		Right Angle Plug	N/A	<b>EZ-195-200-QNM-RA-X</b>	3190-8039	QNMR
SMA	Female	Straight Jack	N/A	<b>EZ-195-200-SF-X</b>	3190-8002	SF
	Male	Straight Plug	Hex	<b>EZ-195-SM-X</b>	3190-6140	SM
		Right Angle Plug	Hex	<b>TC-195-SM-SS-X</b>	3190-2878	SM
TNC	Female	Straight Jack	N/A	<b>EZ-195-200-TF-BH-X</b>	3190-8004	TFB
				<b>EZ-195-TF-RP-X</b>	3190-6166	TFRP
	Male	Straight Plug	Hex/Knurl	<b>EZ-195-TM-X</b>	3190-6496	TM
				<b>EZ-195-TM-RP-X</b>	3190-6142	TMRP
				<b>TC-195-TM-X</b>	3190-6568	TM
	Right Plug	Hex	<b>EZ-195-200-TM-RA-X</b>	3190-8003	TMR	
UHF	Male	Straight Plug	Knurl	<b>EZ-195-200-UM-X</b>	3190-8005	UM
		Right Angle Plug	Knurl	<b>EZ-195-200-UM-RA-X</b>	3190-8006	UMR

\*Connector part numbers in bold text are the default connectors for LMR-195 cable assemblies

Connectors	Gender	Description	Coupling Nut	Part Number	Stock Code	Connector Code
1.0/2.3	Male	Straight Plug	Knurl	<b>EZ-240-1023M-X</b>	3190-6283	1023M
4.3/10	Male	Straight Plug	Hex	<b>EZ-240-4310M-X</b>	3190-6386	43M
		Right Angle Plug	Hex	<b>EZ-240-4310M-RA-X</b>	3190-8094	43MR
7/16 DIN	Male	Straight Plug	Hex	<b>TC-240-716M</b>	3190-2982	DM
		Right Angle Plug	Hex	<b>TC-240-716M-RA-D</b>	3190-2983	DMR
			Hex/Knurl	<b>EZ-240-716M-RA-X</b>	3190-8104	DMR
BNC	Male	Straight Plug	Knurl	<b>EZ-240-BM-X</b>	3190-6406	BM
			TC-240-BM-X	3190-6380	BM	
		Right Angle Plug	Knurl	<b>EZ-240-BM-RA-X</b>	3190-2868	BMR
			TC-240-BM-RA-D	3190-6552	BMR	
F	Male	Straight Plug	Hex	<b>TC-240-FM-X</b>	3190-6773	FM
FME	Male	Straight Plug	Hex	<b>TC-240-FMEM-X</b>	3190-6251	FMEM
Mini UHF	Male	Straight Plug	Knurl	<b>TC-240-MUHF</b>	3190-445	MUF
N	Female	Straight Jack	N/A	<b>EZ-240-NF-X</b>	3190-2795	NF
			N/A	<b>EZ-240-NF-BH-X</b>	3190-6316	NFB
			N/A	TC-240-NF-BH-X	3190-6545	NFB
			N/A	TC-240-NF-PM-X	3190-2889	NF
	Male	Straight Plug	Hex/Knurl	<b>EZ-240-NMH-X</b>	3190-6382	NM
			TC-240-NMH-X	3190-6381	NM	
		Right Angle Plug	Hex/Knurl	<b>EZ-240-NMH-RA-X</b>	3190-6143	NMR
			TC-240-NMH-RA-D	3190-6549	NMR	
QMA	Male	Straight Plug	Knurl	<b>EZ-240-QM-X</b>	3190-6564	QM
		Right Angle Plug	Knurl	<b>EZ-240-QM-RA-X</b>	3190-2895	QMR
QN	Female	Straight Jack	N/A	<b>EZ-240-QNF-X</b>	3190-8042	QNF
	Male	Straight Plug	N/A	<b>EZ-240-QNM-X</b>	3190-8047	QNM
		Right Angle Plug	N/A	<b>EZ-240-QNM-RA-X</b>	3190-8041	QNMR
SMA	Female	Straight Jack	N/A	<b>EZ-240-SF-X</b>	3190-8008	SF
				TC-240-SF-BH-SS-X	3190-2896	SF
	Male	Straight Plug	Hex	<b>EZ-240-SM-X</b>	3190-6319	SM
				TC-240-SM-SS-X	3190-2898	SM
		Right Angle Plug	Hex	<b>EZ-240-SM-RA-X</b>	3190-326	SMRP
				TC-240-SM-RA-SS-D	3190-6551	SMR
TNC	Female	Straight Jack	N/A	<b>EZ-240-TF-X</b>	3190-6204	TF
				<b>EZ-240-TF-BH-X</b>	3190-8009	TFB
				<b>EZ-240-TF-RP-X</b>	3190-6405	TFRP
	Male	Straight Plug	Hex/Knurl	<b>EZ-240-TM-RP-X</b>	3190-2892	TMRP
				<b>EZ-240-TM-X</b>	3190-6494	TM
		Right Angle Plug	Hex/Knurl	TC-240-TM-X	3190-6550	TM
				<b>EZ-240-TM-RA-X</b>	3190-2726	TMR
				TC-240-TM-RA-D	3190-6547	TMR
UHF	Male	Straight Plug	Knurl	<b>EZ-240-UM-X</b>	3190-8010	UM
		Right Angle Plug	Knurl	<b>EZ-240-UM-RA-X</b>	3190-8011	UMR

\*Connector part numbers in bold text are the default connectors for LMR-240 cable assemblies

Connectors	Gender	Description	Coupling Nut	Part Number	Stock Code	Connector Code
4.3/10	Male	Straight plug	Hex	<b>EZ-400-4310M-X</b>	3190-8096	43M
		Right angle plug	Hex	TC-400-4310M-X	3190-6272	43M
7/16 DIN	Male	Straight plug	Hex	<b>EZ-400-4310M-RA-X</b>	3190-8097	43MR
		Right angle plug	Hex	<b>EZ-400-716M-X</b>	3190-2524	DM
				TC-400-716M-X	3190-2597	DM
				<b>EZ-400-716M-RA-X</b>	3190-2545	DMR
BNC	Male	Straight plug	Knurl	<b>EZ-400-716M-RA-D</b>	3190-2598	DMR
		Right angle plug	Knurl	<b>EZ-400-BM-X</b>	3190-2852	BM
				TC-400-BM-X	3190-6232	BM
				<b>EZ-400-BM-RA-X</b>	3190-2847	BMR
HN	Male	Straight plug	Knurl	TC-400-BM-RA-D	3190-6430	BMR
		Right angle plug	Hex/Knurl	<b>TC-400-HNM</b>	3190-923	HNM
Mini UHF		Straight plug	Knurl	<b>TC-400-HNM-RA</b>	3190-2541	HNMR
				<b>TC-400-MUHF</b>	3190-520	MUM
N	Female	Straight jack	N/A	<b>EZ-400-NF-BH-X</b>	3190-6328	NFB
				<b>EZ-400-NF-X</b>	3190-2818	NF
				TC-400-NF-X	3190-2815	NMK
	Male	Straight plug	Hex/Knurl	<b>EZ-400-NMH-X</b>	3190-2590	NM
				<b>EZ-400-NMC-2-D</b>	3190-2640	NMC
				TC-400-NMH-X	3190-2626	NM
				<b>EZ-400-NMK-X</b>	3190-6071	NMK
				TC-400-NMC-2	3190-6077	NMC
				TC-400-NM-RP	3190-960	NMRP
				<b>EZ-400-NMH-RA-X</b>	3190-6342	NMR
Right angle plug	Hex/Knurl	<b>EZ-400-NMH-RA-D</b>	3190-2293	NMR		
QN	Female	Straight jack	N/A	<b>EZ-400-QNF-X</b>	3190-2980	QNM
				<b>EZ-400-QNM-X</b>	3190-8043	QMM
	Male	Straight plug	Knurl	TC-400-QNM-X	3190-6212	QNM
<b>EZ-400-QNM-RA-X</b>				3190-2981	QNMR	
SMA	Female	Straight jack	N/A	<b>EZ-400-SF-X</b>	3190-8023	SF
				TC-400-SF-X	3190-6174	SF
	Male	Straight plug	Hex	<b>EZ-400-SM-X</b>	3190-8021	SM
				TC-400-SM-X	3190-3046	SM
Right angle plug	Hex	<b>EZ-400-SM-RA-X</b>	3190-8022	SMR		
TNC	Female	Straight jack	N/A	<b>EZ-400-TF-X</b>	3190-3049	TF
				<b>EZ-400-TF-BH-X</b>	3190-8024	TFB
				<b>EZ-400-TF-RP</b>	3190-795	TFRP
				TC-400-TF-X	3190-3051	TF
				TC-400-TF-RP	3190-1063	TFRP
	Male	Straight plug	Knurl	<b>EZ-400-TM-X</b>	3190-2533	TM
				TC-400-TM-X	3190-2532	TM
				<b>EZ-400-TM-RP</b>	3190-794	TMRP
				TC-400-TM-RP	3190-1062	TMRP
				<b>EZ-400-TM-RA-X</b>	3190-2800	TMR
Right angle plug	Hex/Knurl	<b>EZ-400-TM-RA-D</b>	3190-6147	TMRRP		
		TC-400-TM-RP-RA-D	3190-6147	TMRRP		
		TC-400-TM-RA-D	3190-2671	TMR		
UHF	Male	Straight plug	Knurl	<b>EZ-400-UM-X</b>	3190-8025	UM
		Right angle plug	Knurl	<b>EZ-400-UM-RA-X</b>	3190-8026	UMR

\*Connector part numbers in bold text are the default connectors for LMR-400 cable assemblies

# LMR® Standard 600

Connectors	Gender	Description	Coupling Nut	Part Number	Stock Code	Connector Code	
BNC	Male	Right Angle Plug	Knurl	<b>TC-600-BM-RA-D</b>	3190-2734	BMR	
DIN	7-16 Female	Straight Jack	N/A	<b>EZ-600-716F-X</b>	3190-2447	DF	
				TC-600-716FC	3190-375	DF	
	7-16 Male	Straight Plug	Hex	<b>EZ-600-716M-X</b>	3190-2643	DM	
				TC-600-716M-X	3190-2642	DM	
				<b>EZ-600-716M-RA-X</b>	3190-6471	DMR	
	Right Angle Plug	Hex	TC-600-716M-RA-D	3190-6211	DMR		
EIA FLANGE	7/8	Flange	N/A	<b>EZ-600-78EIA</b>	3190-1373	78EIA	
HN	Male	Straight Plug	Knurl	<b>TC-600-HNMC</b>	3190-1429	HNM	
LC	Male	Straight Plug	Hex	<b>TC-600-LCM</b>	3190-1406	LCM	
4.3/10	4.3/10 Male	Straight	Hex	<b>TC-600-4310M-X</b>	3190-6273	43M	
		Straight Plug	Hex	<b>EZ-600-4310M-X</b>	3190-8100	43M	
		Right Angle Plug	Hex	<b>EZ-600-4310M-RA-X</b>	3190-8101	43MR	
N	Female	Straight Jack	N/A	<b>EZ-600-NF-X</b>	3190-2817	NF	
				<b>EZ-600-NF-BH-X</b>	3190-8034	NFB	
				TC-600-NF-X	3190-2816	NF	
				TC-600-NF-BH	3190-589	NFB	
	Male	Straight Plug	Hex/Knurl	Knurl	<b>EZ-600-NMK</b>	3190-669	NM
				Hex/Knurl	<b>EZ-600-NMH-X</b>	3190-2627	NM
				<b>EZ-600-NMC-2-D</b>	3190-2641	NM	
				TC-600-NMC-2-D	3190-6122	NM	
				TC-600-NMH-X	3190-2628	NM	
				Right Angle Plug	Hex/Knurl	<b>EZ-600-NMH-RA-X</b>	3190-6387
<b>TC-600-NMH-RA-D</b>	3190-2427	NMR					
QN	Female	Straight Jack	N/A	<b>EZ-600-QNF-X</b>	3190-8050	QNF	
	Male	Straight Plug	N/A	<b>EZ-600-QNM-X</b>	3190-8048	QNM	
		Right angle plug	N/A	<b>EZ-600-QNM-RA-X</b>	3190-8049	QNMR	
SMA	Male	Straight Plug	Hex	<b>EZ-600-SM-X</b>	3190-8111	SM	
TNC	Female	Straight Jack	N/A	<b>TC-600-TF-RP</b>	3190-1065	TFRP	
				<b>EZ-600-TF-X</b>	3190-3050	TF	
				<b>EZ-600-TF-BH-X</b>	3190-8035	TFB	
				<b>EZ-600-TF-RP</b>	3190-797	TFRP	
				TC-600-TF-X	3190-3052	TF	
	Male	Straight Plug	Hex/Knurl	Knurl	<b>EZ-600-TM-RP</b>	3190-796	TMRP
				Hex/Knurl	TC-600-TM-RP	3190-1064	TMRP
				<b>EZ-600-TM-X</b>	3190-2531	TM	
				TC-600-TM-X	3190-2530	TM	
				Right Angle Plug	Hex/Knurl	<b>TC-600-TM-RA-D</b>	3190-2707
UHF	Male	Straight Plug	Knurl	<b>EZ-600-UM-X</b>	3190-8036	UM	
		Straight Angle Plug	Knurl	<b>EZ-600-UM-RA-X</b>	3190-8037	UMR	

\*Connector part numbers in bold text are the default connectors for LMR-600 cable assemblies

Connectors	Gender	Description	Coupling Nut	Part Number	Stock Code	Connector Code
DIN	7-16 Female	Straight Jack	N/A	<b>EZ-900-716FC-2-SP</b>	3190-6512	DF
	7-16 Male	Straight Plug	Hex	<b>EZ-900-716MC-2-SP</b>	3190-6452	DM
EIA FLANGE	7/8	Straight	N/A	<b>EZ-900-78EIA-2-SP</b>	3190-6441	78EIA
		Right Angle	N/A	<b>EZ-900-78EIA-RA-2-SP</b>	3190-6442	78EIAR
N	Female	Straight Jack	N/A	<b>EZ-900-NFC-2-SP</b>	3190-6444	NF
	Male	Straight Plug	Hex/Knurl	<b>EZ-900-NMC-2-SP</b>	3190-6443	NM

\* Connector part numbers in bold text are the default connectors for LMR-900 cable assemblies

Connectors	Gender	Description	Coupling Nut	Part Number	Stock Code	Connector Code
DIN	7-16 Female	Straight Jack	N/A	<b>EZ-1200-716FC-2</b>	3190-2784	DF
	7-16 Male	Straight Plug	Hex	<b>EZ-1200-716MC-2</b>	3190-2781	DM
EIA FLANGE	7/8	Straight	N/A	<b>EZ-1200-78EIA-2</b>	3190-2780	78EIA
		Right Angle	N/A	<b>EZ-1200-78EIA-RA-2</b>	3190-2782	78EIAR
N	Female	Straight Jack	N/A	<b>EZ-1200-NFC-2</b>	3190-2785	NF
	Male	Straight Plug	Hex/Knurled	<b>EZ-1200-NMC-2</b>	3190-2783	NM

\* Connector part numbers in bold text are the default connectors for LMR-1200 cable assemblies

## 195

Installation Tools	Description	Part Number	Stock Code
Combination Strip Tool	Prep Tool for LMR-195 and 200	CST-195/200	3192-102
Crimp Tool	Crimp tool for LMR-195,200 and 240	CT-240/200/195/100	3192-256
Universal Crimp Tool	Universal, heavy-duty crimp handle	CT-U	3192-181
Crimp Dies	LMR-195 crimp dies (0.213" hex) for use with the CT-U	Y197	3190-610
Cutting Tool	Spring loaded LMR cutting tool	CCT-03	3192-267
Debur Tool	Center conductor debur tool	DBT-U	3192-001
Replacement Blade Kit	Replacement blade for all CST prepping tools	RB-CST	3192-086
	Replacement blade for the CCT-03 cutting tool	RB-03	3192-337
Tool Pouch	Embroided tool pouch with zipper	FKP-01	3190-584
Hardcase Tool Kit	Connector Attachment Tools for LMR-195, 200 and 240	TK-195/200/240EZ-HC	660-1206
Hardware	Description	Part Number	Stock Code
Weather Seal Boot	Weather Seal strain relief boot (10 pack)	WSB-195/200	3109-445
Silicone Tape	Self-bonding silicone tape (for six connections)	WK-S-1	WK-S-1
Cold Shrink	Cold Shrink for LMR-200 to LMR-600	CS-2060T	CS-2060T
Ground Kit	Standard ground kit for LMR-195	GK-S195TT	GK-S195TT
Crimp Ferrule	(Bags of 10) CR-195-X- Crimp Ferrule, Copper LMR-195 SERIES	CR-195-X	3190-6110

## 240

Installation Tools	Description	Part Number	Stock Code
Combination Strip Tool	Prep Tool for LMR-240	CST-240A	3192-152
Crimp Tool	Crimp tool for LMR-195,200 and 240	CT-240/200/195/100	3192-256
Universal Crimp Tool	Universal, heavy-duty crimp handle	CT-U	3192-181
Crimp Dies	LMR-240 crimp dies (0.255" hex) for use with the CT-U	Y375	3190-608
Cutting Tool	Spring loaded LMR cutting tool	CCT-03	3192-267
Pin Crimp Tool	Pin Crimp Tool for N's, 4.3's and 7/16 DIN's	PCT-401	3192-216
Debur Tool	Center conductor debur tool	DBT-U	3192-001
Replacement Blade Kit	Replacement blade for all CST prepping tools	RB-CST	3192-086
	Replacement blade for the CCT-03 cutting tool	RB-03	3192-337
Tool Pouch	Embroided tool pouch with zipper	FKP-01	3190-584
Hardcase Tool Kit	Connector Attachment Tools for LMR-195, 200 and 240	TK-195/200/240EZ-HC	660-1206
Hardware	Description	Part Number	Stock Code
Weather Seal Boot	Weather Seal strain relief boot (10 pack)	WSB-240	3109-400
Silicone Tape	Self-bonding silicone tape (for six connections)	WK-S-1	WK-S-1
Cold Shrink	Cold Shrink for LMR-200 to LMR-600	CS-2060T	CS-2060T
Ground Kit	Standard ground kit for LMR-240	GK-S240TT	GK-S240TT
Crimp Ferrule	(Bags of 10) CR-240-X- Crimp Ferrule, Copper LMR-240 SERIES	CR-240-X	3190-6111

## 400

Installation Tools	Description	Part Number	Stock Code
Combination Strip Tool	Prep Tool for LMR-400	CST-400	3192-004
Crimp Tool	Crimp tool for LMR-400	CT-400/300	3190-666
Universal Crimp Tool	Universal, heavy-duty crimp handle	CT-U	3192-181
Crimp Dies	LMR-400 crimp dies (0.429" hex) for use with the CT-U	Y1719	3190-202
Cutting Tool	Spring loaded LMR cutting tool	CCT-03	3192-267
Mid-Span Strip Tool	Prep Tool for Ground Strap Attachment	GST-400A	3190-2174
Pin Crimp Tool	Pin Crimp Tool for N's, 4.3's and 7/16 DIN's	PCT-400	3192-217
Replacement Blade Kit	Replacement blade for all CST prepping tools	RB-CST	3192-086
	Replacement blade for the CCT-03 cutting tool	RB-03	3192-337
Tool Pouch	Embroided tool pouch with zipper	FKP-01	3190-584
Hardcase Tool Kit	Connector Attachment Tools for LMR-400 and LMR-400-75	TK-400/400-75EZ-HC	660-1266
Soft Pouch Tool Kit	Connector Attachment Tools for LMR-400	TK-400EZ	3190-1601
Hardware	Description	Part Number	Stock Code
Weather Seal Boot	Weather Seal strain relief boot (10 pack)	WSB-400	3109-394
	Over connector weather protection for LMR-400 and N male	WPB-400-NM	3192-6122
Silicone Tape	Self-bonding silicone tape (for six connections)	WK-S-1	WK-S-1
Weather Seal Kit	Universal weather proofing kit (for six connections)	WK-U	WK-U
Cold Shrink	Cold Shrink for LMR-200 to LMR-600	CS-2060T	CS-2060T
	Cold Shrink for LMR-400 to LMR-600	CS-4060T	CS-4060T
Ground Kit	Standard ground kit for LMR-400	GK-S400TT	GK-S400TT
Pull Hoist	pre-laced pull hoist for LMR-400	HG-400T	HG-400T
Hangers	Standard hanger for LMR-400 and LMR-600	BH-S38-NH	BH-S38-NH
Support Blocks	Mini coax support blocks for LMR-400	CB-400T	CB-400T
Crimp Ferrule	(Bags of 10) CR-400-X- Crimp Ferrule, Copper LMR-400 SERIES	CR-400-X	3190-6113

# Standard • Installation Tools and Hardware

## 600

Installation Tools	Description	Part Number	Stock Code
Combination Strip Tool	Prep Tool for LMR-600	CST-600	3192-052
Crimp Tool	Crimp tool for LMR-600	CT-600	3192-170
Universal Crimp Tool	Universal, heavy-duty crimp handle	CT-U	3192-181
Crimp Dies	LMR-600 crimp dies (0.610" hex) for use with the CT-U	Y1720	3190-203
Cutting Tool	LMR cutting tool	CCT-02	3192-165
Mid-Span Strip Tool	Prep Tool for Ground Strap Attachment	GST-600A	3190-1051
Pin Crimp Tool	Pin Crimp Tool for N's, 4.3's and 7/16 DIN's	PCT-600	3192-266
Replacement Blade Kit	Replacement blade for all CST prepping tools	RB-CST	3192-086
	Replacement blade for the CCT-02 cutting tool	RB-02	3192-166
Tool Pouch	Embroided tool pouch with zipper	FKP-01	3190-584
Soft Pouch Tool Kit	Connector Attachment Tools for LMR-600	TK-600EZ	3190-1602
Hardware	Description	Part Number	Stock Code
Weather Seal Boot	Weather Seal strain relief boot (10 pack)	WSB-600	3109-401
	Over connector weather protection for LMR-600 and N male	WPB-600-NM	3192-6163
Silicone Tape	Self-bonding silicone tape (for six connections)	WK-S-1	WK-S-1
Weather Seal Kit	Universal weather proofing kit (for six connections)	WK-U	WK-U
Cold Shrink	Cold Shrink for LMR-200 to LMR-600	CS-2060T	CS-2060T
Cold Shrink	Cold Shrink for LMR-400 to LMR-600	CS-4060T	CS-4060T
Ground Kit	Standard ground kit for LMR-600	GK-S600TT	GK-S600TT
Pull Hoist	Lace-up pull hoist for LMR-600	HG-600T	HG-600T
Hangers	Standard hanger for LMR-400 and LMR-600	BH-S38-NH	BH-S38-NH
Support Blocks	Mini coax support blocks for LMR-600	CB-600T	CB-600T
Crimp Ferrule	(Bags of 10) CR-600-X- Crimp Ferrule, Copper LMR-600 SERIES	CR-600-X	3190-6115

## 900

Installation Tools	Description	Part Number	Stock Code
Strip Tool	Prep Tool for LMR-900	ST-900C	3190-1310
Cutting Tool	LMR cutting tool	CCT-02	3192-165
Wrench	1 1/4" open end wrench (2 required)	WR-900	3190-509
Mid-Span Strip Tool	Prep Tool for Ground Strap Attachment	GST-900A	3190-435
Replacement Blade Kit	Replacement blade for the CCT-02 cutting tool	RB-02	3192-166
Tool Pouch	Embroided tool pouch with zipper	FKP-01	3190-584
Hardware	Description	Part Number	Stock Code
Silicone Tape	Self-bonding silicone tape (for six connections)	WK-S-1	WK-S-1
Weather Seal Kit	Universal weather proofing kit (for six connections)	WK-U	WK-U
Cold Shrink	Cold Shrink for LMR-600 to LMR-1200	CS-60120T	CS-60120T
Ground Kit	Standard ground kit for LMR-900	GK-S900TT	GK-S900TT
Pull Hoist	Lace-up pull hoist for LMR-900	HG-900T	HG-900T
Hangers	Butterfly hanger for LMR-900	BH-58-NH	BH-58-NH
Support Blocks	Mini coax support blocks for LMR-900	CB-900T	CB-900T

## 1200

Installation Tools	Description	Part Number	Stock Code
Strip Tool	Prep Tool for LMR-1200	ST-1200CH	3192-124
Cutting Tool	LMR cutting tool	CCT-02	3192-165
Wrench	1 9/16" open end wrench (1 required)	WR-1200A	3190-512
	1 7/16" open end wrench (1 required)	WR-1200B	3190-511
Mid-Span Strip Tool	Prep Tool for Ground Strap Attachment	GST-1200A	3190-436
Replacement Blade Kit	Replacement blade for the CCT-02 cutting tool	RB-02	3192-166
Tool Pouch	Embroided tool pouch with zipper	FKP-01	3190-584
Hardware	Description	Part Number	Stock Code
Silicone Tape	Self-bonding silicone tape (for six connections)	WK-S-1	WK-S-1
Weather Seal Kit	Universal weather proofing kit (for six connections)	WK-U	WK-U
Cold Shrink	Cold Shrink for LMR-600 to LMR-1200	CS-60120T	CS-60120T
Ground Kit	Standard ground kit for LMR-1200	GK-S1200TT	GK-S1200TT
Pull Hoist	Lace-up pull hoist for LMR-1200	HG-1200T	HG-1200T
Hangers	Butterfly hanger for LMR-1200	BH-78-NH	BH-78-NH
Support Blocks	Mini coax support blocks for LMR-1200	CB-1200T	CB-1200T



## TK-195/200/240EZ-HC Tool Kit

Identifying the proper tools for a job, making sure that you have all of the necessary tools and storing them in such a way that they are quickly accessible, has been a timeless challenge. Especially, when working at a remote job site. This new hard case tool kit with hard foam cut-outs for LMR-195, 200 and 240 goes a long way towards addressing the challenge. This is the first in a series of hardcase kits which will keep all of the tools required for a specific job all in one place. All it takes is a quick flip of the lid to make sure you have everything you need.

660-1206



- TK-195/200/240EZ-HC
- For LMR-195, 200 and 240
- X series connectors

### Tools include the following:

- CT-240/200/100  
Crimp tool for LMR-240, LMR-200 and LMR-100 connectors
- CST-195/200  
Prep tool for LMR-195 and LMR-200 connectors
- CST-240A  
Prep tool for LMR-240
- CCT-03  
Cable cutting tool for LMR-100 through LMR-600



# TK-195/200/240EZ-HC • Tool Kit

## CST-195/200

STOCK CODE 3192-102

Prep tool for LMR-195 and LMR-200 connectors – tested to over 2000 preps. RB-CST replacement blade package available.

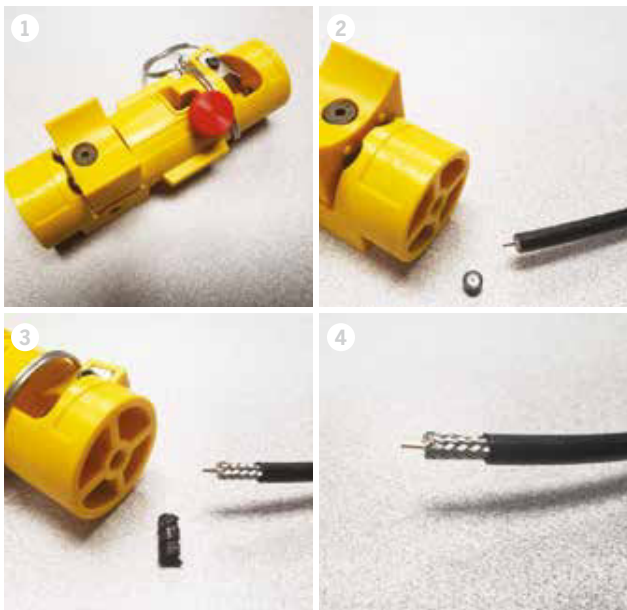

## CST-240A

STOCK CODE 3192-152

Prep tool for LMR-240 – tested to over 2000 preps. RB-CST replacement blade package available.

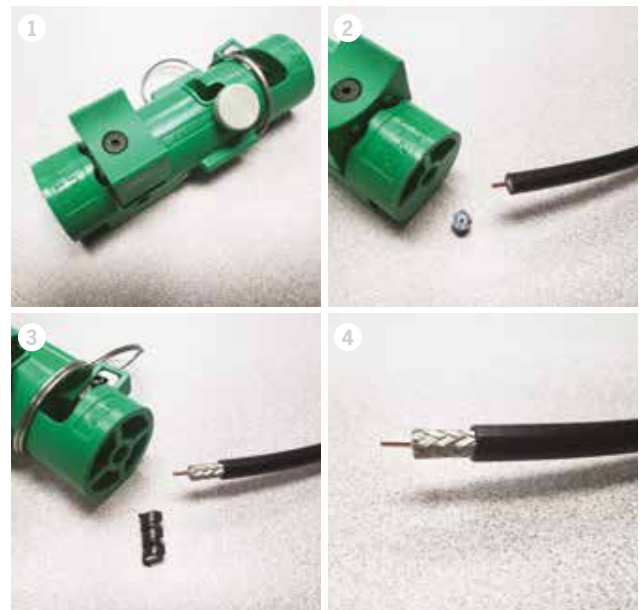

## CT-240/200/100

STOCK CODE 3192-256

Crimp tool for LMR-240, LMR-200 and LMR-100 connectors – tool has a cam adjustment that can be used to minimize the required crimp force.



### Hex Dies include:

- 0.128" hex, 0.213" hex and 0.255" hex.

## CCT-03

STOCK CODE 3192-267

Cable cutting tool for LMR-100 through LMR-600.



- Spin the CCT-03 around the cable letting the spring do the work until the cable snaps. This will provide a clean, square cut, leaving the cable completely round and the center conductor straight and burr free. This blade has been tested to over 2000 cuts.

**Kit:** • Part Number **TK-195/200/240EZ-HC** • Stock Code **660-1206**